



Model: E2S  
ID: LSWE2S

ENGLISH

MLSE2S04

## iotty Smart Shades Switch

Model: E2S  
ID: LSWE2S  
Input 230 Vac  
Frequency 50Hz  
Max 5A per RL  
Ambient temperature: 25°C  
Operating temperature: from 0°C to 40°C  
Only works with 2.4GHz Wi-Fi band

## Supports

- Motors for rolling shutters, awnings, sun screens or skylights.
- Motors with maximum nominal consumption 350W
- Motors with a blocking current of less than 12A

Frequency range: 2412-2472MHz  
Maximum RF output power  
of the product: 17.29 dBm

## RF exposure information:

The Maximum Permissible Exposure (MPE) level is calculated based on a distance of d=20 cm between the device and the human body. To maintain compliance with the RF exposure requirement, a separation distance of 20 cm between the device and the human should be maintained.

IOTTY srl  
Via Del Laghetto, 18/20  
33080 Porcia (PN) - ITALY  
iotty@iotty.com  
support@iotty.com

Input L/N should be connected to a 16A circuit breaker, and each way output should be connected to a 5A circuit breaker before used.

## Important Notes

### Safety Precaution

Install in accordance with all national and local codes.

Hire a professional electrician if you are not familiar or not comfortable with electrical work, or if the wiring in your electrical box looks different from the pictures.

For indoor use and dry location only.

### Installation Precaution

Neutral wire required.

### Troubleshooting

1. In case the glass faceplate is already on the device but the switch or the touch doesn't work, reset the switch in this order:

- From the app (soft reset) [Device settings > Reset device],
- OR
- By powering off and then back on the circuit breaker,

2. In case of network error, try these steps in order and wait some minute for the re-connection after each step:

- Restart the router,
- OR
- Remove the faceplate and push the Reset button on the switch.
- OR
- Remove the faceplate and push the AP button on the switch. Repeat device registration (see point 6 of instructions).

Restore the touch sensitivity with a soft reset every time you put the faceplate back to place (see point 1 of troubleshooting).

## Warranty

For warranty information visit us at  
[iotty.com/warranty](http://iotty.com/warranty)

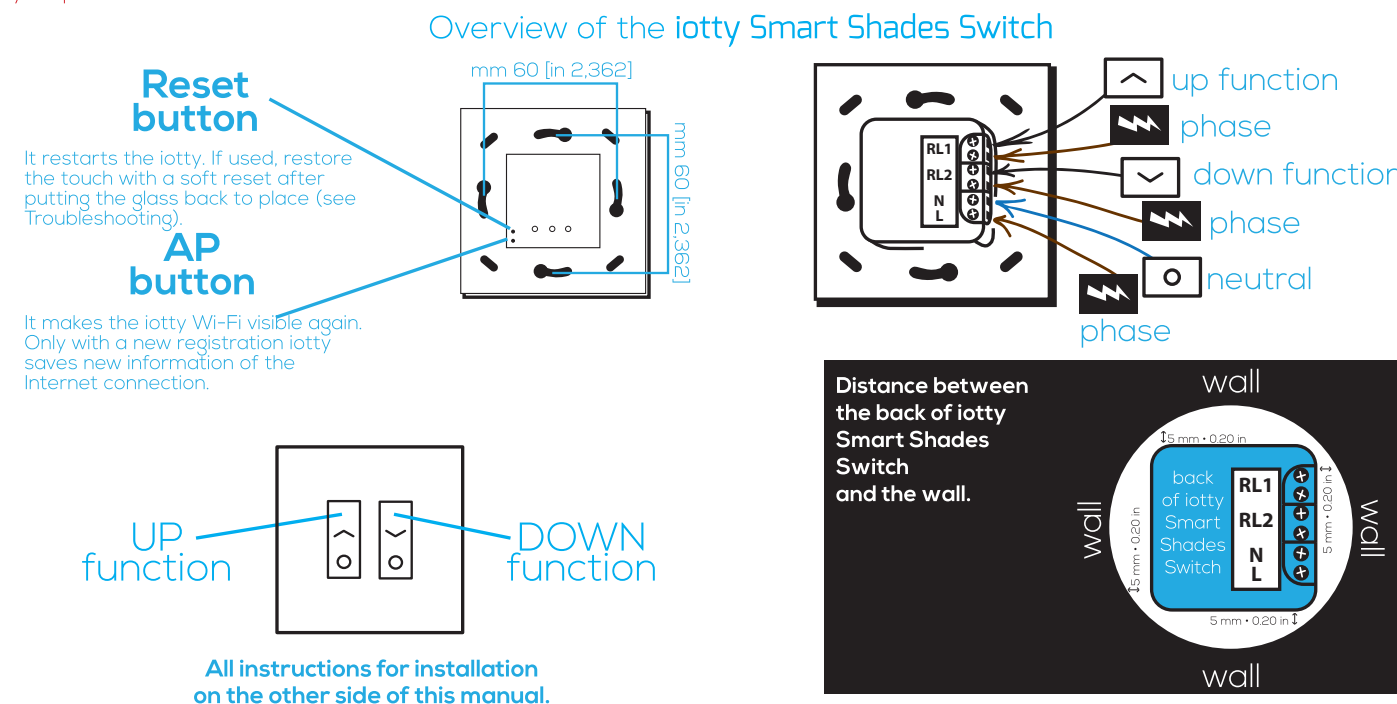

All instructions for installation  
on the other side of this manual.

More info at:  
[iotty.com](http://iotty.com)

WARNING: Electrical wirings should be done by a professional electrician. Incorrect installation is dangerous or illegal. Please call a professional electrician if you are unfamiliar or uncomfortable with electrical work.

Read the **Important Notes** on the other side of this manual before starting the installation.

1

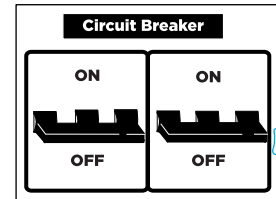

Turn off the power at the circuit breaker for the switch you are replacing.

2

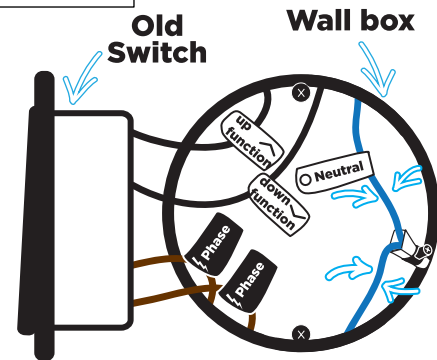

Remove your old switch and label your wires. Remember that you must have a neutral wire to install iotty Smart Shades Switch.

3

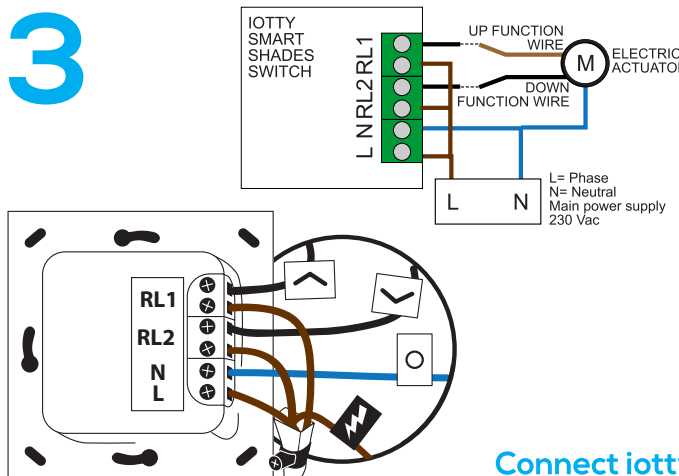

Connect iotty

Insert the neutral wire into the screw terminal labeled with N. Insert the phase into the screw terminal L and into one screw terminal of RL1. Insert the **up function wire** into the free screw terminal of RL1. Insert the **down function wire** into the free screw terminal of RL2. If you have a ground wire, place it into the wall box.

Input L/N should be connected to a 16A circuit breaker, and each way output should be connected to a 5A circuit breaker before used.

4

Screw in iotty

○ = recommended screw holes

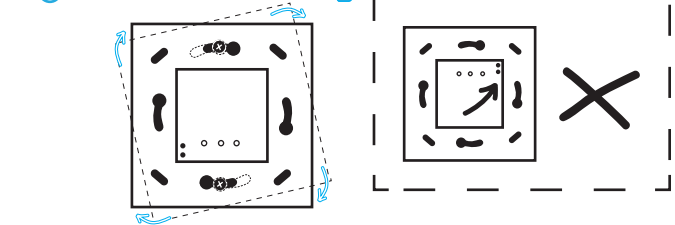

Push all the wires back into the wall box and try to allow as much space for the switch as possible. (Do not push the wires using the back of the switch). Insert the iotty Smart Shades Switch in the wall box screws. Position the switch so that the buttons are located at the bottom.

5

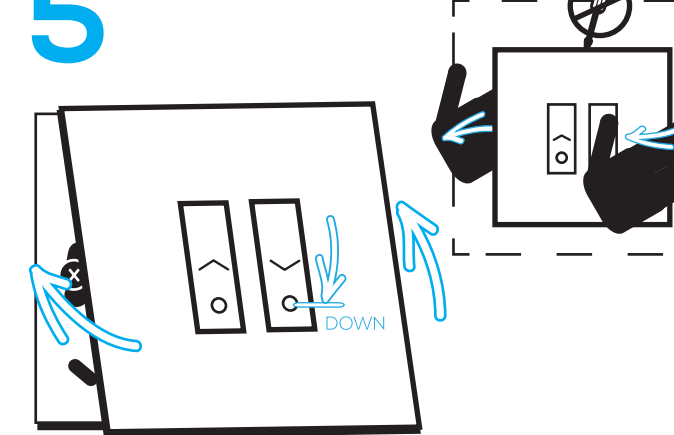

Attach your iotty Smart Shades Switch faceplate. To remove, use your hands to lift the faceplate. Position the faceplate so that the little circle is located at the bottom.

6

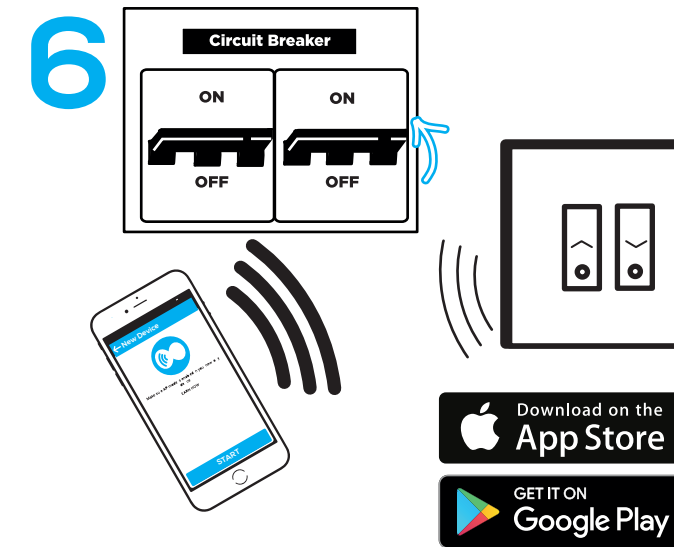

Turn on the power at the circuit breaker. Download the iotty app, sign in and add a new device.

iotty devices are compatible with the following integrations:



If you need more information you can contact us at [support@iotty.com](mailto:support@iotty.com) or visit our FAQ section



WARNING: Electrical wirings should be done by a professional electrician. Incorrect installation is dangerous or illegal. Please call a professional electrician if you are unfamiliar or uncomfortable with electrical work.