



Model: OSWDE
ID: OSWDE

ENGLISH

MOSFR04

iotty Smart Outlet
Model: OSWDE
ID: OSWDE
Input 230 Vac
Frequency 50Hz
Max 16A
Ambient temperature: 25°C
Operating temperature: from 0°C to 40°C
Only works with 2.4GHz Wi-Fi band

Frequency range: 2412-2472MHz
Maximum RF output power
of the product: 17.29 dBm

RF exposure information:
The Maximum Permissible Exposure (MPE) level is calculated
based on a distance of d=20 cm between the device and the
human body. To maintain compliance with the RF exposure
requirement, a separation distance of 20 cm between the
device and the human should be maintained.

Warranty

For warranty information visit us at
iotty.com/warranty

IOTTY srl
Via Del Laghetto, 18/20
33080 Porcia (PN) - ITALY
iotty@iotty.com
support@iotty.com

Safety Precaution

Install in accordance with all national and local codes.

Hire a professional electrician if you are not familiar or not comfortable
with electrical work, or if the wiring in your electrical box looks different
from the pictures.

For indoor use and dry location only.

Installation Precaution

Phase, neutral and ground wire are required.

Troubleshooting

1. In case the glass faceplate is already on the device but the switch or
the touch doesn't work, reset the switch in this order:

- From the app (soft reset) [Device settings > Reset device],
- OR**
- By powering off and then back on the circuit breaker,

2. In case of network error, try these steps in order and wait some
minute for the re-connection after each step:

- Restart the router,
- OR**
- Remove the faceplate and push the Reset button on the switch.
- OR**
- Remove the faceplate and push the AP button on the switch. Repeat
device registration (see point 6 of instructions).

Restore the touch sensitivity with a soft reset every time you put the
faceplate back to place (see point 1 of troubleshooting).

Important Notes

Input L/N should be connected to a 16A circuit breaker.

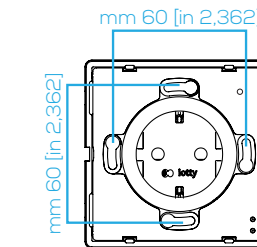

AP button

It makes the iotty Wi-Fi visible
again. Only with a new registration
iotty saves new information of the
Internet connection.

Reset button

It restarts the iotty. If used,
restore the touch with a soft reset
after putting the glass back to
place (see Troubleshooting).

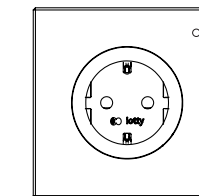

ON-OFF switch

To easily switch on and off
the power of the outlet
no need of unplugging the
household appliance.

**All instructions for installation
on the other side of this manual.**

Overview of the iotty Smart Outlet

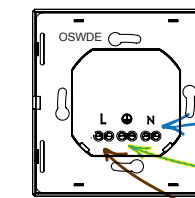

neutral

ground

phase

**Distance between
the back of
iotty Smart Outlet
and the wall.**

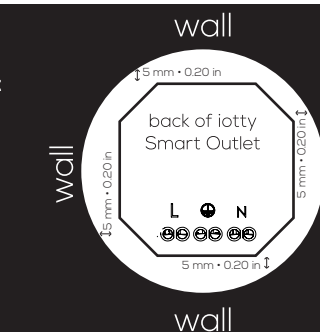

WARNING: Electrical wirings should be done by a professional electrician. Incorrect installation is dangerous or illegal. Please call a professional electrician if you are unfamiliar or uncomfortable with electrical work.

More info at:
iotty.com

Read the **Important Notes** on the other side of this manual before starting the installation.

1

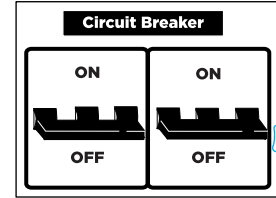

Turn off the power at the circuit breaker for the switch you are replacing.

2

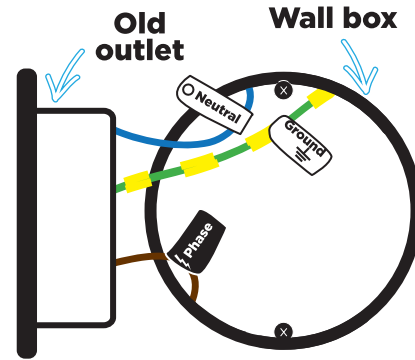

Remove your old outlet and label your wires.

3

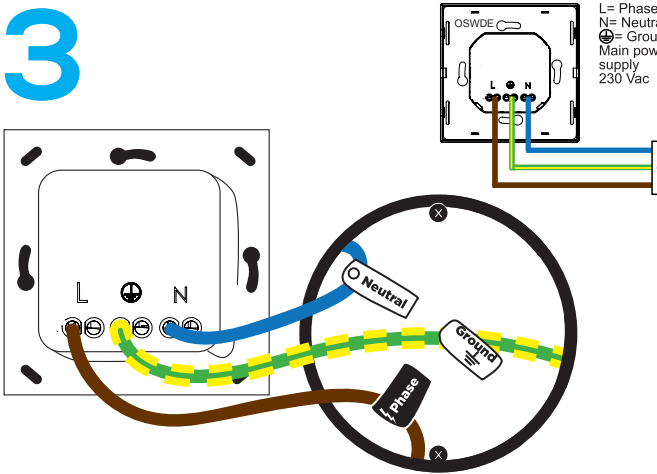

Connect iotty

Use only one entrance for each terminal. Only if needed, the double screw terminal can be used to jumper cables.

Insert the **phase wire** into the screw terminal labeled with **L**. Insert the **ground wire** into the central screw terminal with the **ground symbol**. Insert the **neutral wire** into the screw terminal **N**.

4

Screw in iotty

○ = recommended screw holes

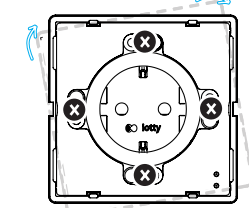

Push all the wires back into the wall box and try to allow as much space for the switch as possible. (Do not push the wires using the back of the switch). Screw the iotty Smart Outlet into the wall box.

Place the switch so that the physical buttons are located at the bottom.

Input L/N should be connected to a 16A circuit breaker.

5

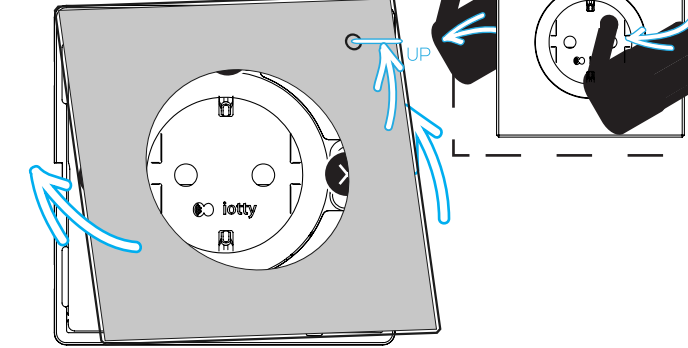

Attach your iotty Smart Outlet faceplate.

To remove it, use your hands to lift the faceplate. Place the faceplate so that the little circle is located at the top.

6

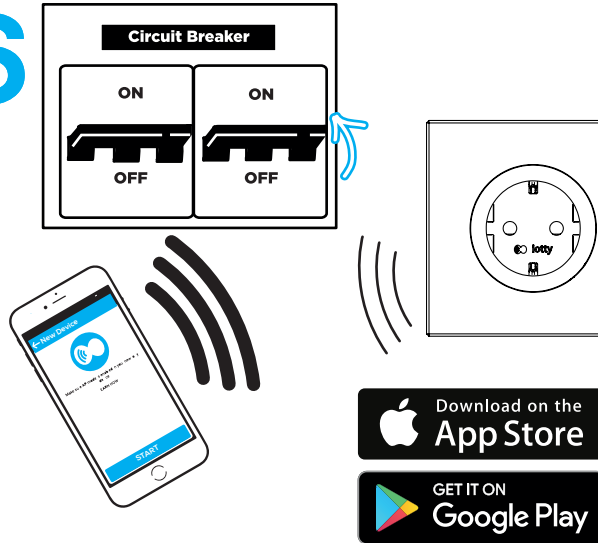

Turn on the power at the circuit breaker. Download the iotty app, sign in and add a new device.

iotty devices are compatible with the following integrations:



If you need more information you can contact us at support@iotty.com or visit our FAQ section

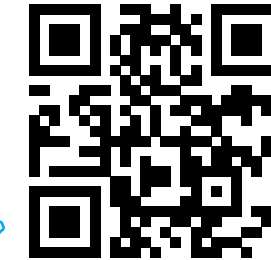

WARNING: Electrical wirings should be done by a professional electrician. Incorrect installation is dangerous or illegal. Please call a professional electrician if you are unfamiliar or uncomfortable with electrical work.